

13" FRONT EXTENSION - MOUNTING INSTRUCTIONS

INSTALLATION ONTO STANDARD LIFTS

PURCHASED AFTER JAN. 1, 1994

POSITION THE 13" EXTENSION OVER THE EXISTING TABLE AS SHOWN AND ATTACH WITH FOUR 5/16 -18 x 3/4 CAP SCREWS, NUTS AND LOCKWASHERS PROVIDED. DIAGRAM #1.

NOTE: ALL ACCESSORIES MUST BE REMOVED BEFORE INSTALLING EXTENSION.

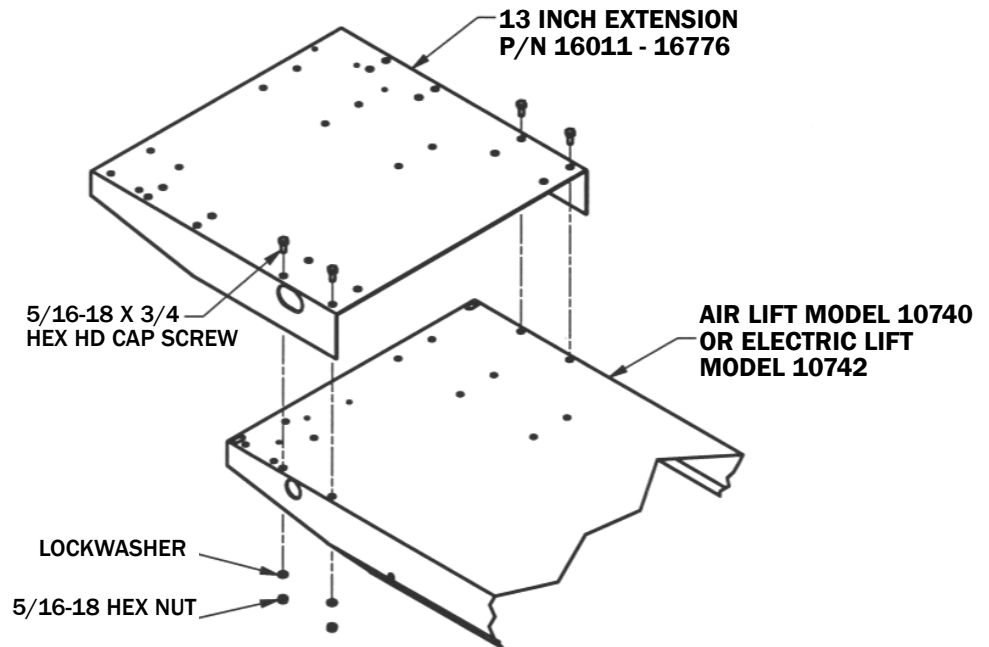

INSTALLATION ONTO S.A.M. 1000 LIFTS

POSITION THE 13" EXTENSION OVER THE EXISTING TABLE AS SHOWN AND ATTACH WITH FOUR 3/8-16 X 1 CAP SCREWS, NUTS AND LOCKWASHERS PROVIDED. DIAGRAM #2.

NOTE: ALL ACCESSORIES MUST BE REMOVED BEFORE INSTALLING EXTENSION.

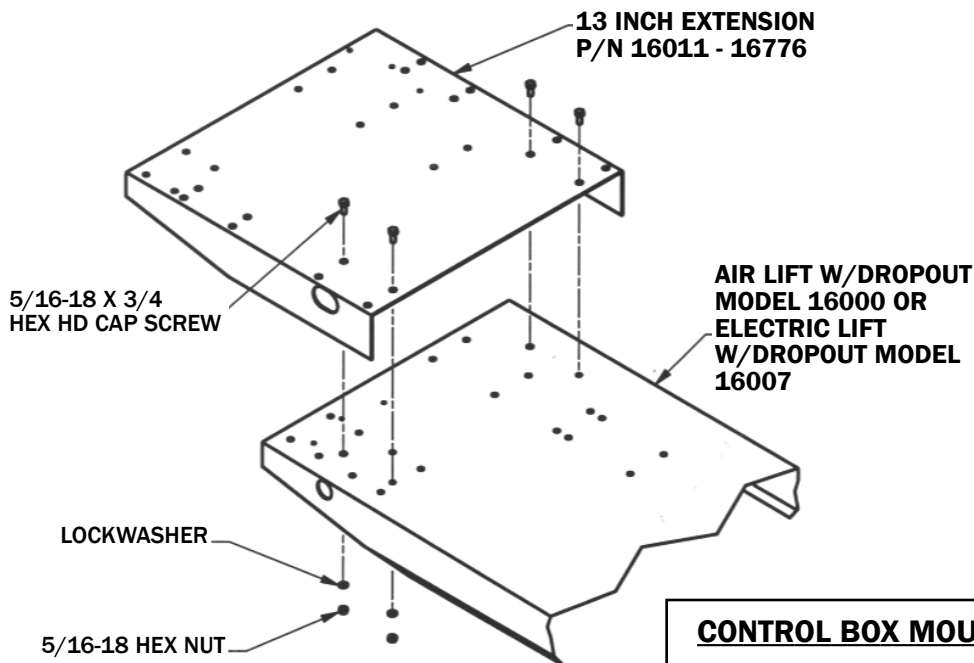

CONTROL BOX MOUNTING FOR FRONT EXTENSION

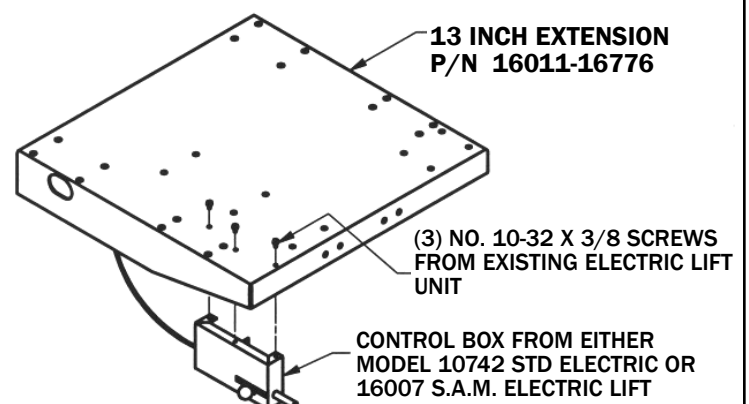

ERROR: invalidfont
OFFENDING COMMAND: stringwidth

STACK:

(DIA)
12.8936
2
0
0.225